





 **Snowdragon Industrial Co.,Ltd**  
**DATA SHEET**

LED neon light Installation

\*Flexible neon accessories: power supply components, Mid-joint, front connections, extended joints, the end plug, fixed clip, metal rail, plastic track , front connection, mid-joint

		
Front connections	Mid-joint	The end plug
		
Power supply components	Extended joints	Track

\* Connectors

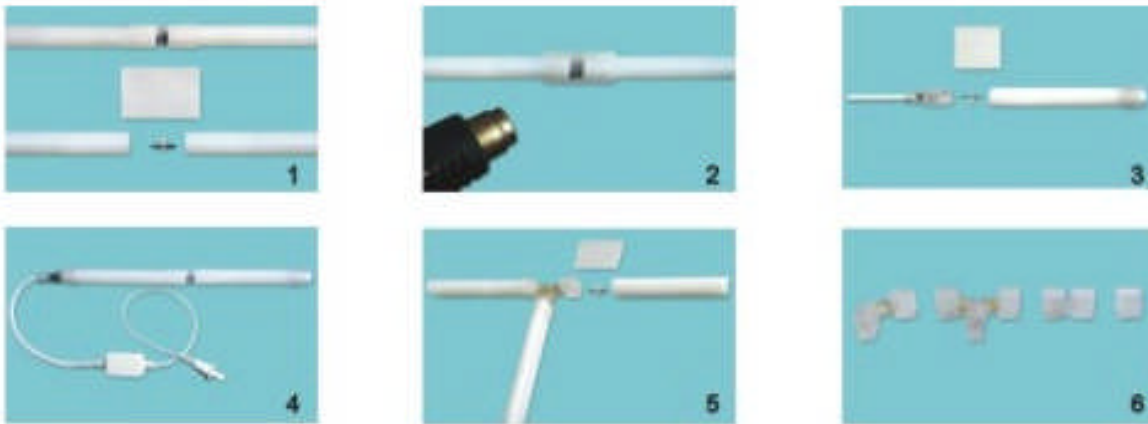

1. Connect with mid joint
2. Connect with tube
3. Male and female connection with front connections
4. Front connection wire
5. T connecting
6. L connecting
7. L, T, Mid, End connectors

- \*            1. 1. Shear marks                            2. Linear installation



3. Curving installation



4. 90 degree installation



5. 180 degrees installation.



6. 360 degree installation



\*Installation Notes:

- Before the packaging is not open, please do not unplug it! (Avoid overheat if not entirely spread from the reel);
- Before the neon flex are not fully installed , please do not unplug them .

Technology support or Order , pls email us : [powerledmanufacturer@gmail.com](mailto:powerledmanufacturer@gmail.com)

- In connection with the connector pins, swing body lights around, cut off excess wire
  - To ensure that the supply voltage in line with the led neon flex , let the polarity in compliance too
  - LED can not be replaced or repaired. If the power cord is damaged, please re-purchase from the supplier;
  - To avoid electric shock or fire, do not use the products whose insulations have been damaged; Avoid pushpins or other sharp things as far as possible to , so as to avoid insulation damage.
  - Lights should not be submerged in the liquid body, try not to expose to water
  - You can only cut at shear logo.
- g fuses or power outlet are grounded, or GFCI
- When the LED flexible neon is lighting Do not cover by other items;
- \* To obey the basic safety precautions, so as not to reduce the fire, electric shock and personal injury, when the circuit should be provided ground fault protection indirectly, such as providin

## Installation steps

\* Let the plug connected flexible LED neon lights to test whether the lights can be light or not;

Then put up the whole roll of the neon light with a wooden frame, and install it on the wall slowly ; (Note : Flexible LED neon lights can not be removed from the plastic spool, and then up high, or it will easily lead to the main line of body lights in fracture); when installing when you find the lights in the middle do not light , cut the unlighted unit , and then use connectors(or positive and negative connections) to link up on both sides of the lighting units, if outdoors installation, please use silicone to seal the joints to keep waterproof; or you can put the PVC sleeve to seal them.

If it is installed on the glass , First you need to use AB plastic to make the trunkings/channels fixed to the glass, then install the lights ,Outdoor use silicone to sealed among plug connectors and the ends to ensure waterproofing. If necessary, additional PVC casing can be sealed, etc..